

SS0115

DUAL-PANEL THERMO-WATCH WITH COUNT-DOWN TIMER

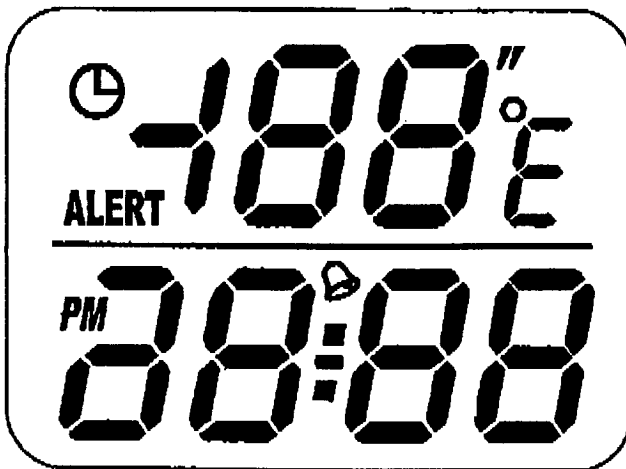

FEATURES

- . Low Operating Voltage : 1.2-1.65V
- . Low Standby Current (typ. 2uA)
- . Operating Current (typ. 25uA) during temperature measurement (every 10sec)
- . 4-digit LCD clock (hour / minute)
- . Date display (month / day)
- . Alarm Clock function (hour / minute)
- . Count down timer (max. 23 : 59 : 00)
- . Temperature measurement range from -20 ~ +70 degC (-4 ~ +158 degF)
- . Temperature accuracy : +/- 1 degC
- . degC / degF switchable
- . FREEZE-ALERT function
- . KEY-TONE

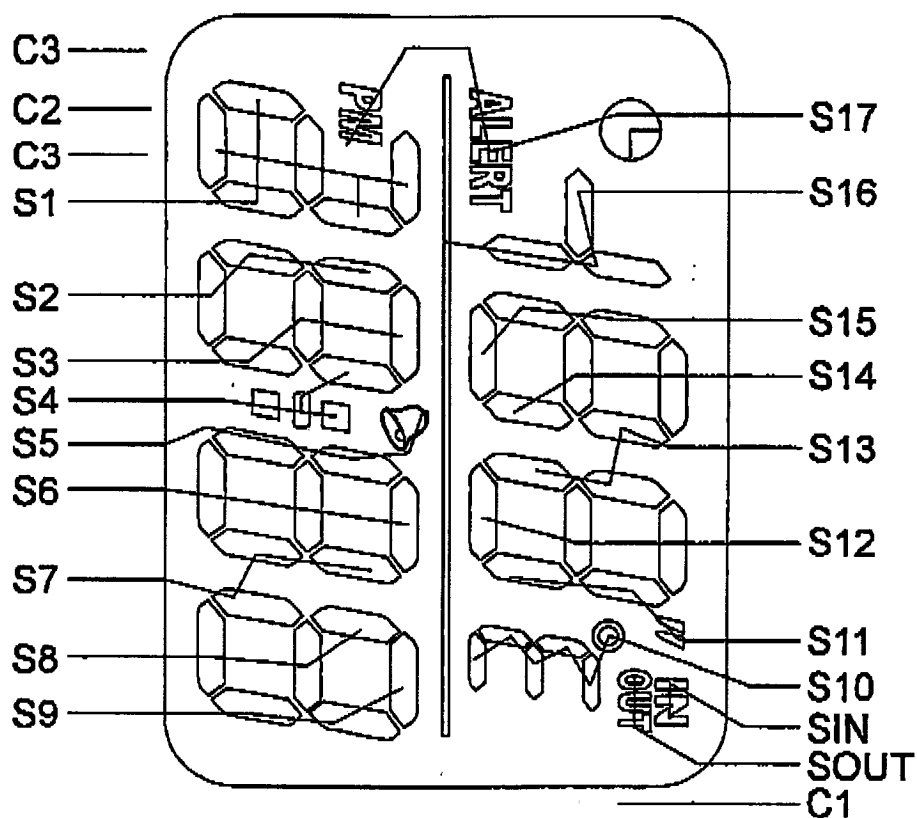

V_{CCD} : 3V
1/3 DUTY, 1/2 BIAS

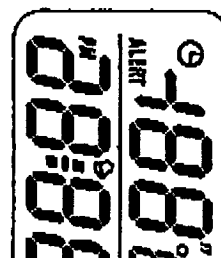
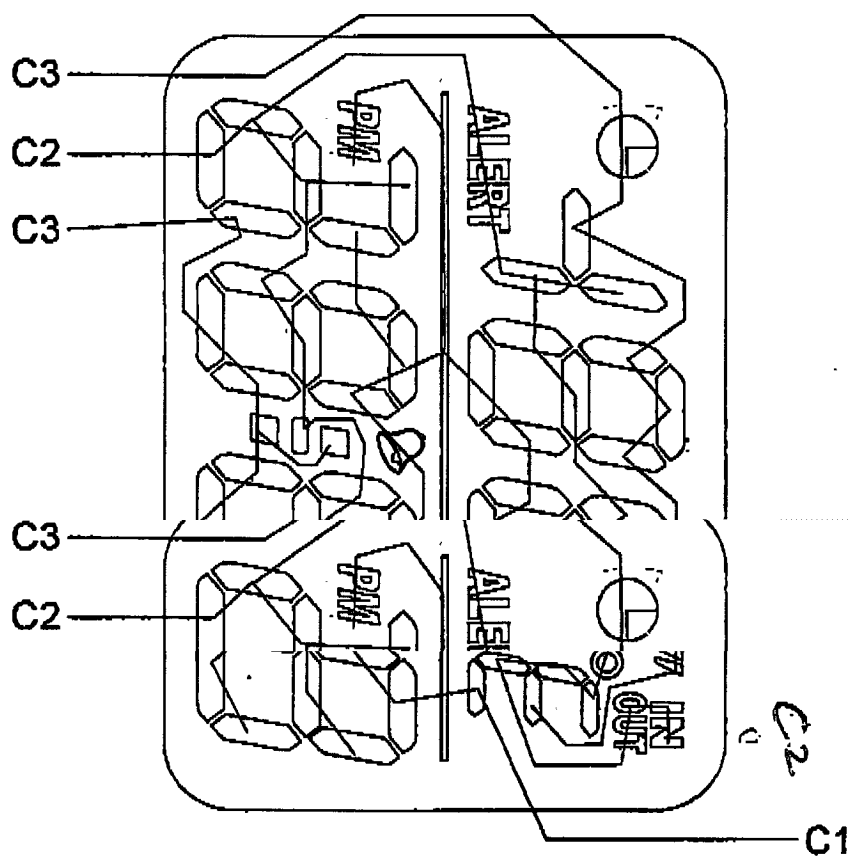

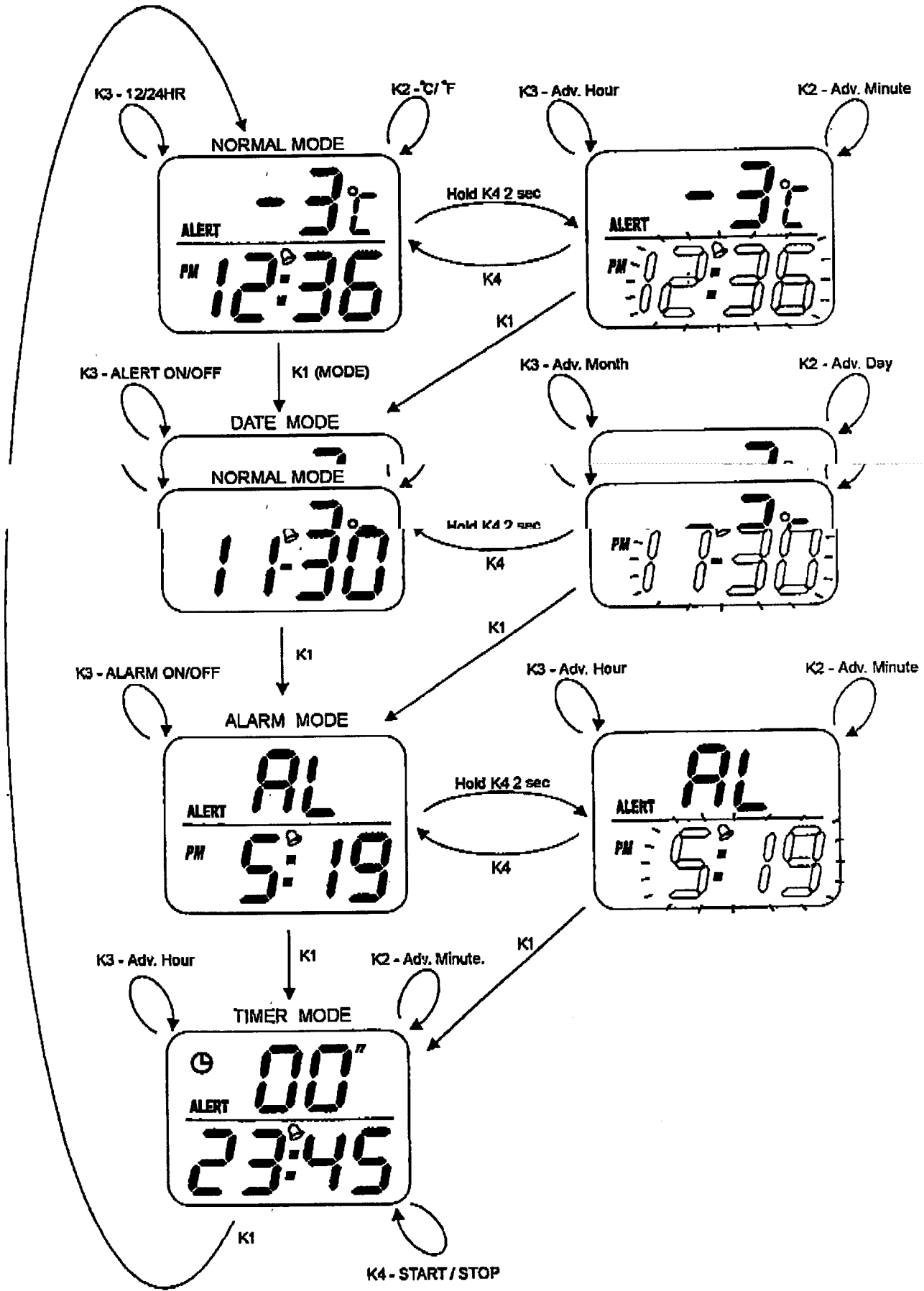

BOND PAD DIAGRAM

SUNSTAR 半导体集成电路 <http://www.icasic.com/> TEL: 0755-83387030 FAX:0755-83376182 E-MAIL:szss20@163.com

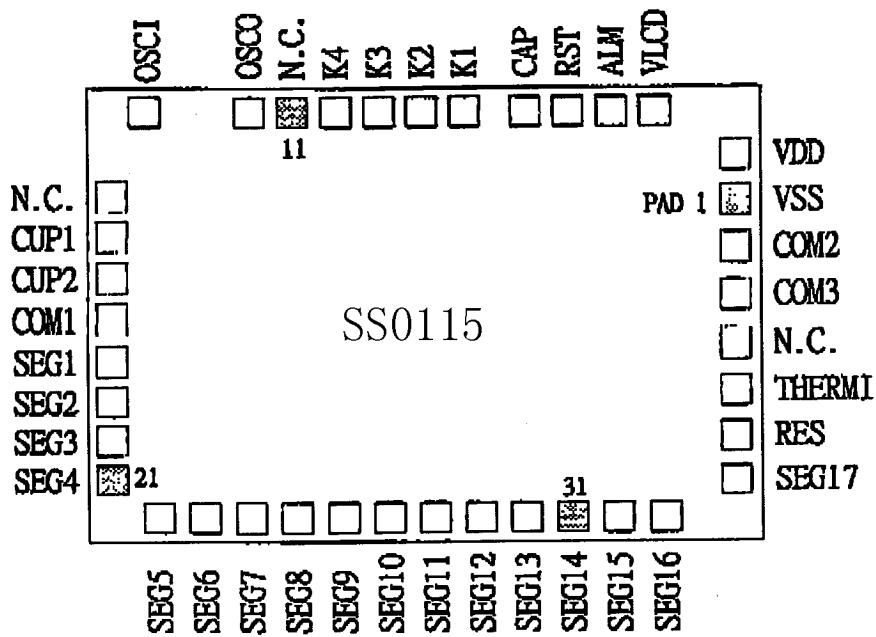

PAD ASSIGNMENT

| Pad No. | Name | Coordinate | | Pad No. | Name | Coordinate | |
|---------|---------|------------|--------|---------|---------|------------|-------|
| | | X | Y | | | X | Y |
| 1 | VSS | 1909.5 | 1128.6 | 21 | SEG4 | 85.5 | 199.5 |
| 2 | VDD | 1909.5 | 1275.6 | 22 | SEG5 | 234.0 | 88.5 |
| 3 | VLCD | 1757.4 | 1500.6 | 23 | SEG6 | 381.0 | 88.5 |
| 4 | ALM | 1610.4 | 1500.6 | 24 | SEG7 | 519.0 | 88.5 |
| 5 | RST | 1465.8 | 1500.6 | 25 | SEG8 | 657.0 | 88.5 |
| 6 | CAP | 1327.8 | 1500.6 | 26 | SEG9 | 795.0 | 88.5 |
| 7 | K1 | 1152.0 | 1500.6 | 27 | SEG10 | 933.0 | 88.5 |
| 8 | K2 | 1023.0 | 1500.6 | 28 | SEG11 | 1071.0 | 88.5 |
| 9 | K3 | 894.0 | 1500.6 | 29 | SEG12 | 1209.0 | 88.5 |
| 10 | K4 | 765.0 | 1500.6 | 30 | SEG13 | 1347.0 | 88.5 |
| 11 | RESERVE | 636.0 | 1500.6 | 31 | SEG14 | 1485.0 | 88.5 |
| 12 | OSCO | 498.0 | 1500.6 | 32 | SEG15 | 1623.0 | 88.5 |
| 13 | OSCI | 155.1 | 1500.6 | 33 | SEG16 | 1761.0 | 88.5 |
| 14 | RESERVE | 85.5 | 1132.5 | 34 | SEG17 | 1909.5 | 219.6 |
| 15 | CUP1 | 85.5 | 994.5 | 35 | RES | 1909.5 | 375.6 |
| 16 | CUP2 | 85.5 | 865.5 | 36 | THERMI | 1909.5 | 527.1 |
| 17 | COM1 | 85.5 | 736.5 | 37 | RESERVE | 1909.5 | 678.6 |
| 18 | SEG1 | 85.5 | 607.5 | 38 | COM3 | 1909.5 | 830.1 |
| 19 | SEG2 | 85.5 | 478.5 | 39 | COM2 | 1909.5 | 981.6 |
| 20 | SEG3 | 85.5 | 349.5 | | | | |

Note : The substrate must be connected to VSS.

SUNSTAR 半导体集成电路 <http://www.icasic.com/> TEL: 0755-83387016 FAX:0755-83376182 E-MAIL:szss20@163.com

SUNSTAR单片机专用电路 <http://www.icasic.com/> TEL: 0755-83387030 FAX:0755-83376182 E-MAIL:szss20@163.com

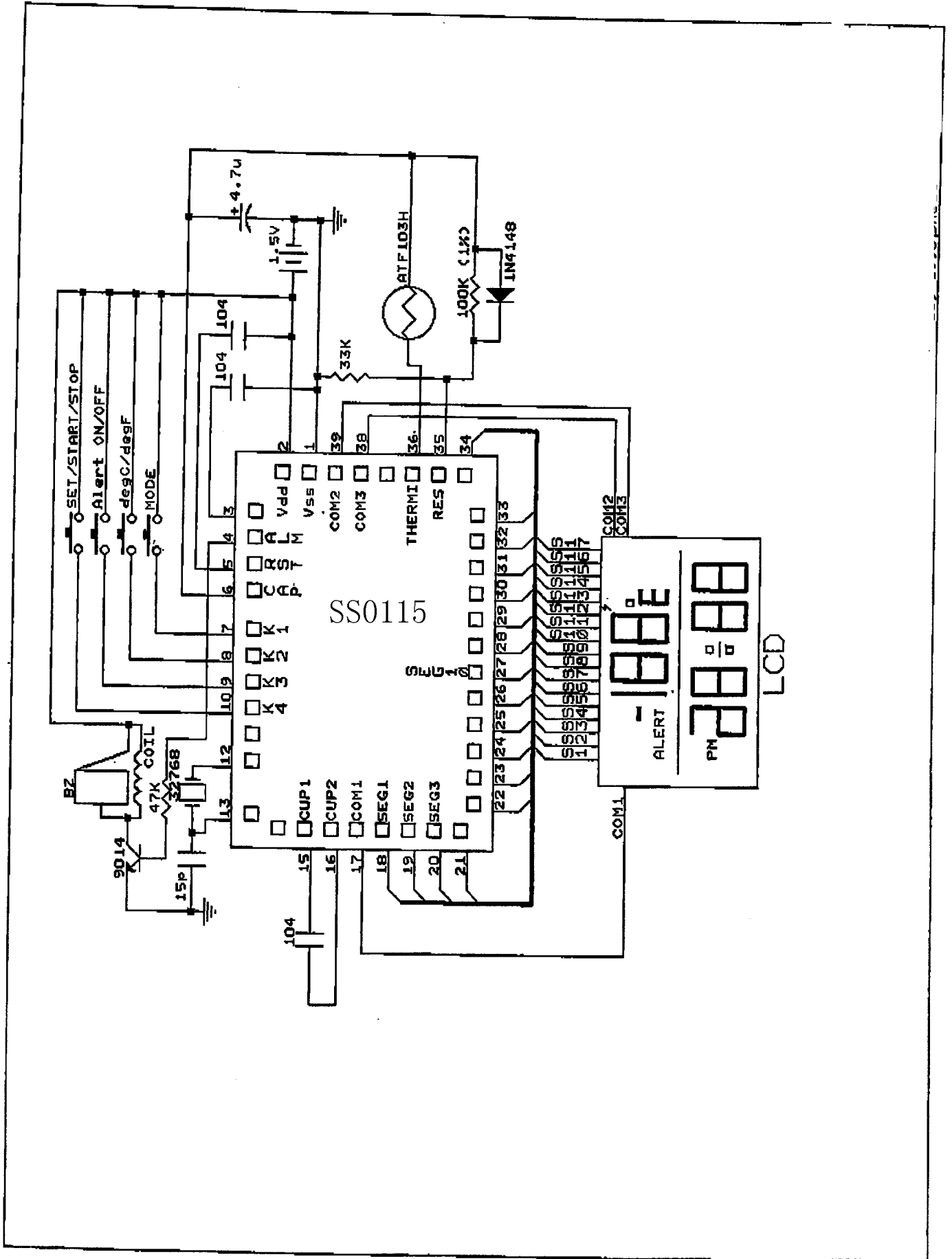

SUNSTAR半导体集成电路 <http://www.icasic.com/> TEL: 0755-83387016 FAX:0755-83376182 E-MAIL:szss20@163.com

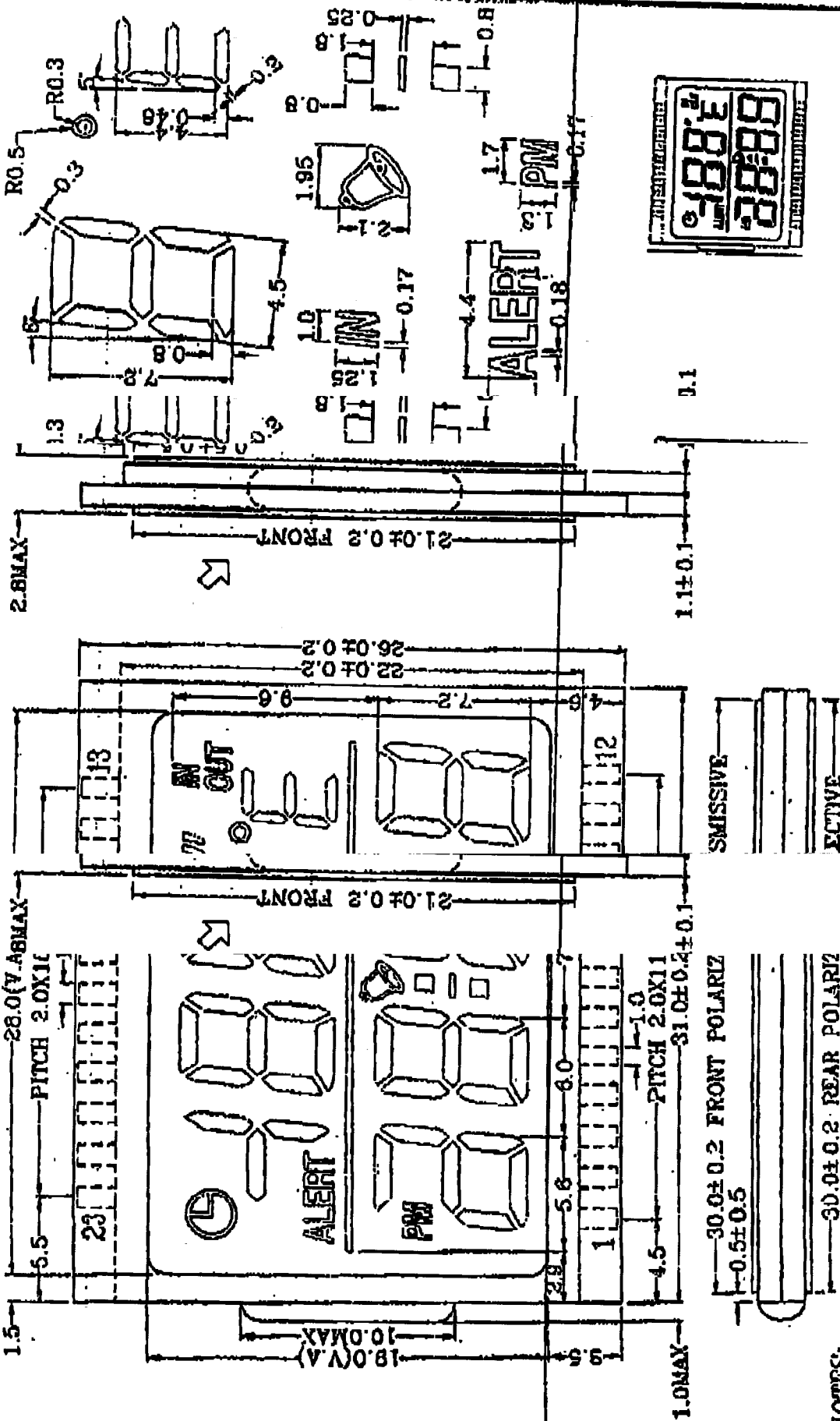

NOTES:

1. DISPLAY TYPE: TN.
2. VIEWING DIRECTION: 12 O'CLOCK
3. DRIVE METHOD: 1/3DUTY, 1/2BIAS.
4. OPERATING VOLTAGE: 3.0V.
5. POLARIZER MODE: REFLECTIVE/POST
6. OPERATING TEMP: -0--+50C.
7. STORAGE TEMP: -10--+60C.

欢迎索取免费详细资料、设计选型指南和光盘、样品；产品繁多未能尽录，欢迎来电查询。

[中国传感器科技信息网：HTTP://WWW.SENSOR-IC.COM/](http://WWW.SENSOR-IC.COM/)

[工控安防网：HTTP://WWW.PC-PS.NET/](http://WWW.PC-PS.NET/)

[消费电子专用电路网：HTTP://WWW.SUNSTARE.COM/](http://WWW.SUNSTARE.COM/)

E-MAIL：xjr5@163.com szss20@163.com

MSN：suns8888@hotmail.com

QQ: 195847376

地址：深圳市福田区福华路福庆街鸿图大厦 1602 室

电话：0755-83376549 83376489 83387030 83387016

传真：0755-83376182 83338339 邮编：518033 手机：(0)13902971329

深圳展销部：深圳华强北路赛格电子市场 2583 号 TEL/FAX：
0755-83665529 25059422

北京分公司：北京海淀区知春路 132 号中发电子大厦 3097 号

TEL：010-81159046 82615020 13501189838 FAX：010-82613476

上海分公司：上海市北京东路 668 号上海赛格电子市场 2B35 号

TEL：021-28311762 56703037 13701955389 FAX：021-56703037

西安分公司：西安高新开发区 20 所(中国电子科技集团导航技术研究所)
西安劳动南路 88 号电子商城二楼 D23 号

TEL：029-81022619 13072977981 FAX:029-88789382

成都：TEL:(0)13717066236

技术支持：0755-83394033 13501568376