

CTS 420 Series Position Transmitter System

The **CTS 420** is a 2-wire current loop position transmitter system especially suited to valve position indication and other position indication in process industries. The system consists of an LVDT position sensor with matching electronics to provide 4-20 mA output into 2-wire current loops. The linear position sensors are available in six ranges covering 0- 0.25" to 0-10.0". The CTS 420 System is particularly well suited for sensing valve position of stem-type valves because the sensor can be coupled directly to the valve's operating shaft for exceptional reliability and accuracy. Of special interest to the process industries is that the system's inductance and capacitance are well below the levels set for intrinsic safety requirements.

The LVDT sensor is constructed of stainless steel and is hermetically sealed and uses a non-contacting movable core, so there is nothing to wear out. The electronics portion of the CTS 420 system is contained on a 3 x 5 inch circuit board which can be installed up to 25 feet from the sensor. All external connections and adjustment controls are mounted directly on the board. The electronics board is also available with an optional splash-proof enclosure.



maximum loop resistance

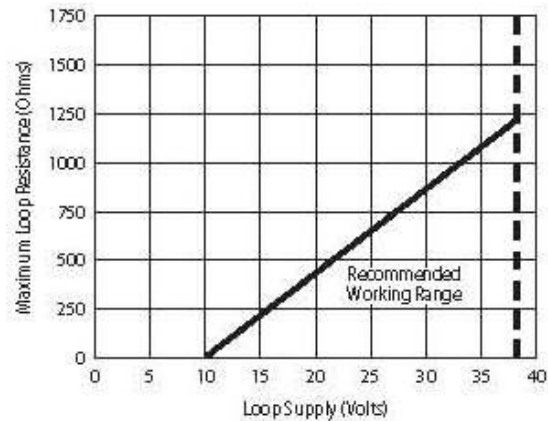

wiring

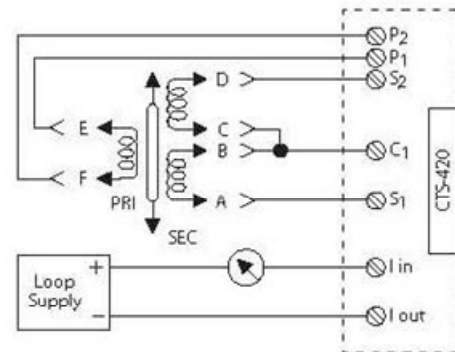

FEATURES

- 4-20 mA Two-Wire Operation
- Measurement Ranges from 0.25" to 10.0"
- Rotary Version 0 to 90°
- Operates in wide temperature range
- Compact Size

OPTIONS

- Rugged Splashproof Housing for Electronics
- Metric Core

CTS 420 Series Position Transmitter System

Specifications

Loop Supply Voltage	15-36 VDC
Max Loop Resistance	11000 @ 36 V
Output	4-20 mA
Frequency Response	100 Hz
Linearity	1.5% of full span output
Stability	0.05% of full span output
Operating Temperature Range (Electronics only)	-40°F to 200°F (-40°C to 95°C)
Thermal Coefficient of Sensitivity	±0.02%/°F (±0.04%/°C) (max)
Controls	Zero and Span

LVDT Specifications

Temperature Range	-65°F to 300°F (-55°C to 150°C)
Housing Material	AISI 400 series stainless steel
Termination	6-pin hermetically-sealed MS connector

dimensions

in (mm)

Module

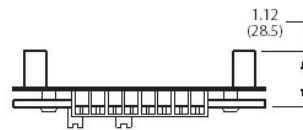
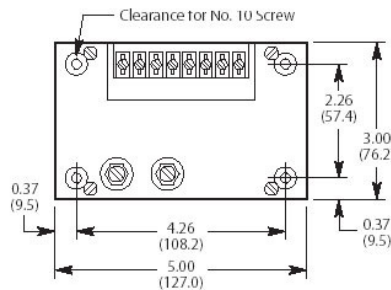

With optional JIC enclosure dimensions are: 6" L x 4" W x 4" H (152 mm x 101.6 mm x 101.6 mm)

LVDT

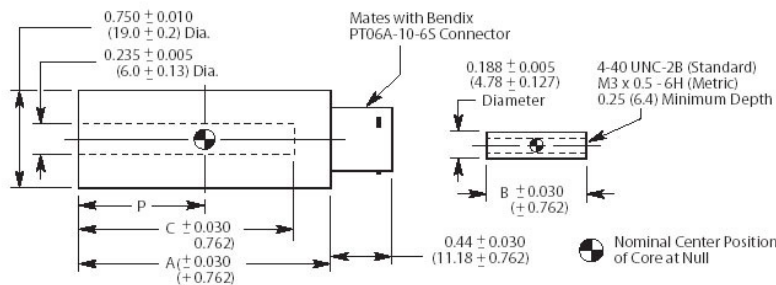

CTS 420 Series Position Transmitter System

Mechanical Specifications

HCT Series Model Number	Weight				Dimensions							
	Weight		Core Weight		A (Body)		B (Core)		P		C	
	Oz	gm	Oz	gm	In	mm	In	mm	In	mm	In	mm
CTS 420-250	1.73	49	0.11	3	2.48	63.0	1.10	27.9	0.96	24.3	1.91	48.5
CTS 420-500	2.58	73	0.14	4	3.84	97.5	1.80	45.7	1.52	38.7	3.25	82.5
CTS 420-1000	2.93	83	0.28	8	5.03	127.8	3.00	76.2	2.23	56.6	4.46	113.2
CTS 420-2000	5.22	148	0.39	11	7.29	185.2	3.80	96.5	3.32	84.3	6.72	171.0
CTS 420-5000	5.65	160	0.46	13	10.68	271.3	5.00	271.3	5.05	128.3	10.2	259.1
CTS 420-10000	10.31	292	0.49	14	19.70	500.1	6.20	157.5	9.53	242.8	19.12	485.6

The information in this sheet has been carefully reviewed and is believed to be accurate; however, no responsibility is assumed for inaccuracies. Furthermore, this information does not convey to the purchaser of such devices any license under the patent rights to the manufacturer. Measurement Specialties, Inc. reserves the right to make changes without further notice to any product herein. Measurement Specialties, Inc. makes no warranty, representation or guarantee regarding the suitability of its product for any particular purpose, nor does Measurement Specialties, Inc. assume any liability arising out of the application or use of any product or circuit and specifically disclaims any and all liability, including without limitation consequential or incidental damages. Typical parameters can and do vary in different applications. All operating parameters must be validated for each customer application by customer's technical experts. Measurement Specialties, Inc. does not convey any license under its patent rights nor the rights of others.

ordering info

Specify the CTS model number with the appropriate range. Add MC to model number for optional metric core. Optional splashproof electronics enclosure is ordered separately.

Ordering Example:

Model Number CTS 420-250-MC is a CTS 420 Series LVDT transmitter with a 0 to 0.250" range and metric core.

model number

CTS 420 Model

Linear Range

CTS 420-250
CTS 420-500
CTS 420-1000

inches	mm
0 to 0.250	0 to 6.35
0 to 0.500	0 to 12.7
0 to 1.0	0 to 25.4

CTS 420-2000

0 to 2.0	0 to 50.8
----------	-----------

CTS 420-4000
CTS 420-10000
CTS-420 90

0 to 4.0	0 to 101.6
0 to 10.0	0 to 254.0
0 to 90°	

options

Metric Core

Add "MC" to model number

Interconnecting Cable

Consult factory for ordering information and pricing

Electronics Enclosure

To order optional JIC enclosure, specify part # 61403006-000 as a separate item.